

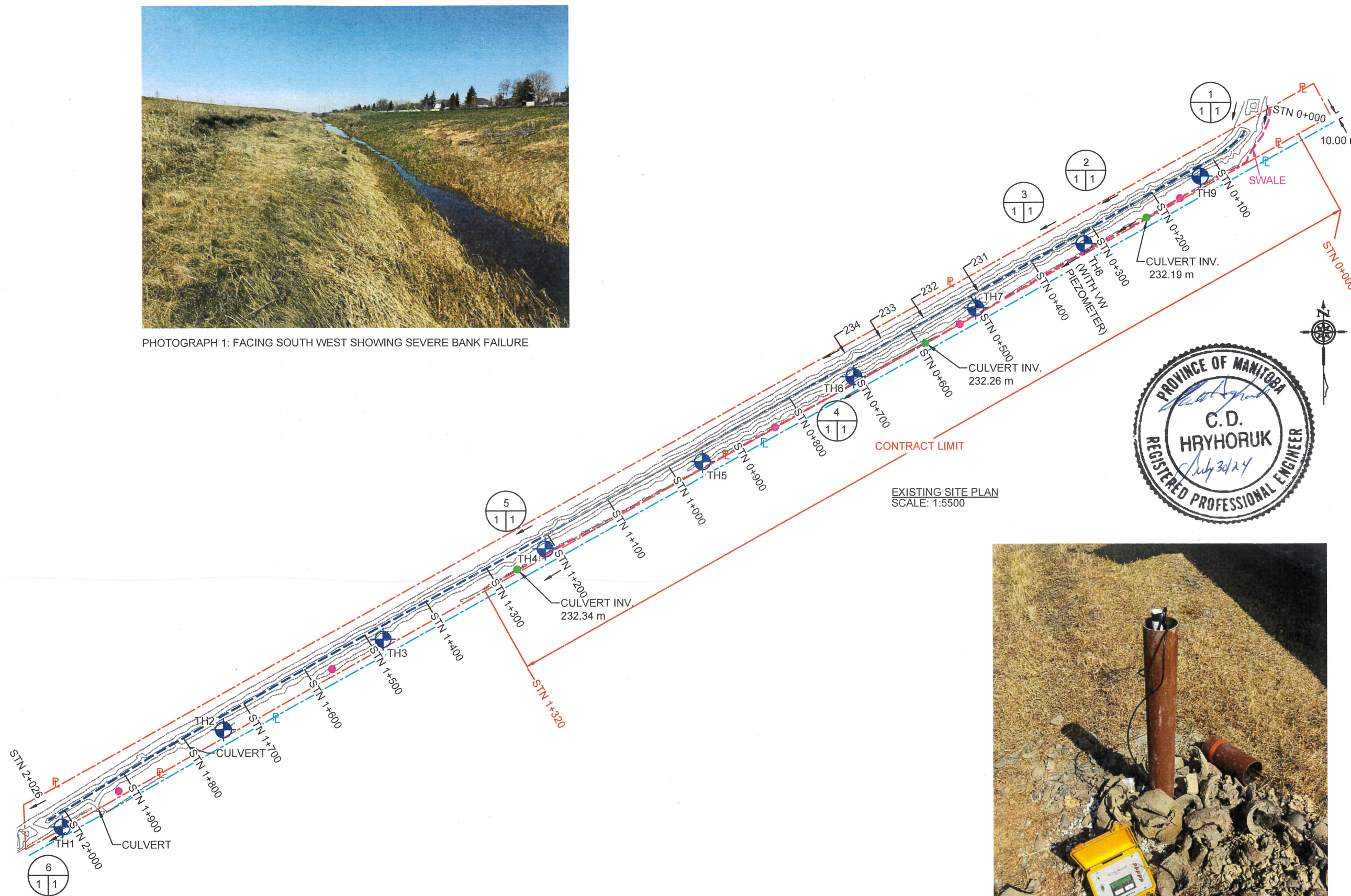

PHOTOGRAPH 1: FACING SOUTH WEST SHOWING SEVERE BANK FAILURE



EXISTING SITE PLAN
SCALE: 1:5500



- LEGEND**
- TH9 TEST HOLE
 - APPROX. DITCH CENTERLINE
 - PROPERTY LINE
 - GIS PROPERTY LINE
 - SECTION/DETAIL No.
 - SECTION / DETAIL PAGE LOCATION
 - SECTION / DETAIL PAGE REFERENCE
 - APPROX. EXISTING SWALE CENTERLINE
 - APPROX. EXISTING HIGH POINT FOR DRAINAGE
 - APPROX. EXISTING LOW POINT FOR DRAINAGE

NOTES

- ALL ELEVATIONS ARE IN METERS UNLESS OTHERWISE NOTED.
- ENG-TECH SURVEYED PROPERTY ON APRIL 16 & 24, 2020 AND AUGUST 22, 2022 USING GPS EQUIPMENT.
- CONTOUR INTERVAL = 1.0 m.
- ONE VW PIEZOMETER WAS INSTALLED IN TH8 AT 7.0 m BELOW GRADE.
- ALL CULVERT LOCATION, CULVERT LENGTH, INVERT ELEV. AND DRAINAGE PATHS ARE APPROXIMATE.
- OUTSIDE DRAIN SWALE GRADES TO BE DETERMINED AFTER EXCAVATION AND COMPACTED BERM CONSTRUCTION.

NO.	DATE	ISSUE / REVISION
0	Jul 2024	tender

ENG-TECH CONSULTING LIMITED
 420 Turenne Street
 Winnipeg, MB
 R2J 3W8
 Phone: (204) 233-1694
 Fax: (204) 235-1579

ENG. STAMP:
ENGINEERS GEOSCIENTISTS MANITOBA
 Certificate of Authorization
 ENG-TECH Consulting Limited
 No. 2475

CLIENT:
CITY OF WINNIPEG

PROJECT:
LOT 16 BANK STABILIZATION

DWG DESCRIPTION:
SITE PLAN, TEST HOLE LOCATION PLAN AND PHOTOGRAPHS 1 AND 2

SCALE:
1:5500

DRAWN BY: RAJ/TB DATE: JULY 2024

FILE No.: 20-217-01 CLIENT DWG/FIG. No.:

ENG-TECH DWG/FIG. No.: NO.:

1 OF 7



PHOTOGRAPH 2: VW PIEZOMETER IS TO BE PRESERVED